

Key Features

- Right angle mount
- Groundplane independent
- RoHS compliant
- Small size: 46mm



General Description

The Siretta Delta 2C antenna combines exceptional performance in a very small size, enabling its use with many of today's GSM / GPRS.

Terminated with an SMA male, SMA reverse polarity, it is ideally suited to applications requiring a simple, cable free set up such as Point of Sale, metering or alarm panels as well as being a popular addition to radio manufacturers' evaluation kits.

The radiating element is an omnidirectional dipole antenna which is over moulded in black high grade rubber giving a rugged, stylish finish.

The Delta 2C is a popular antenna for customers requiring a straightforward to fit, reliable product and is qualified and used with many of today's GSM / GPRS terminals.

Additional Considerations

- A right angled mount ensures the antenna can be flexibly installed with equipment
- Fits to many popular GSM / GPRS terminal equipment
- Does not rely on mounting on metallic surface
- Meets all EU compliance criteria for electronic goods

Rev 1.2

Key Specifications - Electrical

Operating temperature:	-45 to +75°C
Storage temperature:	-45 to +75°C
Impedance:	50 ohm
Gain:	2.15 dBi
Voltage and supply current:	Passive
Max power:	50W
Operating frequencies:	890-960MHz @ <1.5:1 VSWR 1710-1880MHz @ <1.7:1 VSWR
Polarization:	Vertical
Radiating element:	Dipole

Key Specifications - Mechanical

Dimensions:	46mm
Connector:	SMA Male
Mounting method:	Direct connect

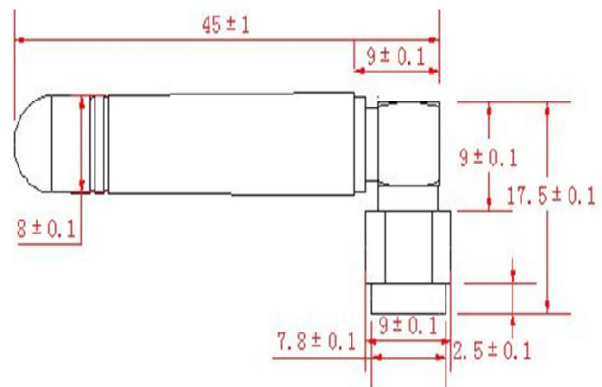

Ordering Details:

Part Number	Description
DELTA2C/X/SMAM/S/RA/23	Quad Band Stubby GSM/GPRS Antenna, SMA Male Connector